

# Shiretoko Daichi Hotel



Government Registration (Tourism Article 1869)  
Japan Ryokan and Hotel Association

Natural World Heritage  
Shiretoko National Park and Utoro Hot Springs



知床第一ホテル

Zip 099-4351 306 Utoro Kagawa Shari-cho, Shari-gun, Hokkaido  
TEL (0152) 24-2334 (Rep.) FAX (0152) 24-2261

Check our website for latest information.  
<http://shiretoko-1.com/>



知床第一ホテル

# Catch your breath “Shiretoko, The Crimson Country”

Shiretoko, a natural world heritage embraced in lush nature,  
promises liberating peace and relaxation.

Here, time passes gently and slowly,  
allowing one to realize that you can be your true self.

As the scenery changes with time,  
there is one thing that remains unchanged and welcoming.  
The Shiretoko Daiichi Hotel is one with Shiretoko's nature,  
and welcomes each guest with kindness and a smile.





# Natural jade panoramic bath “More” and “Rosha”



2F Large Public Bath “Rosha”



Jade, created through millions of years of the earth's activities. Here at the Shiretoko Daiichi Hotel we used 100% natural jade from Myanmar, located at the foot of the Himalayas, for the floors. We provide relaxation like none other in a comfortable space.



## Natural jade, “Green Jewelry Box”, blends well with the nature of Shiretoko.



Children's Heated Pool “Sonte”



Women's Powder Room



1F Large Bath “More”



# Choose from the abundant variation of room types according to your travel style.

(Photos are provided for illustrative purpose only.)



West Wing Japanese-type Twin



West Wing Japanese-Western Room D type



West Wing Special Room



East Wing Japanese Room

## Facility Guide

### Incidental facilities for the family and groups.

We have a large banquet hall that can accommodate up to 350 persons, to medium and small banquet rooms to acquiesce to your needs. There is a pub, Karaoke room, Ramen shop, game corner and gift shop for your pleasure.



Banquet Hall



Snacks Etopirika



Gift Shop

## Facility Guide

	Western Rooms	Japanese Rooms Twin	Japanese Rooms	Japanese-Western Rooms	VIP Rooms	Total	Capacity
West Wing (Smoking room)		16 Rooms	30 Rooms	40 Rooms	2 Rooms	105 Rooms	463 Persons
West Wing (Non-smoking room)		16 Rooms		1 Rooms			
East Wing (Smoking room)	5 Rooms		31 Rooms	4 Rooms		45 Rooms	182 Persons
East Wing (Non-smoking room)			5 Rooms				
Shizenkan (All rooms are non-smoking)		22 Rooms	6 Rooms	29 Rooms	2 Rooms	59 Rooms	252 Persons
<b>Total</b>	<b>5 Rooms</b>	<b>54 Rooms</b>	<b>72 Rooms</b>	<b>74 Rooms</b>	<b>4 Rooms</b>	<b>209 Rooms</b>	<b>897 Persons</b>

All rooms equipped with bath, toilet and air conditioning.

### West Wing

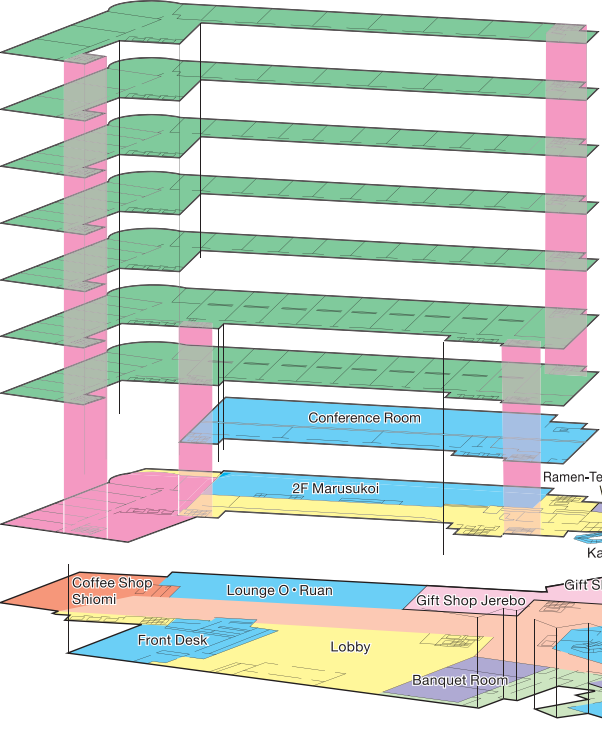

- Banquet Room
  - 44mats(40 persons)× 6 rooms (Max. 240 persons)one stage
  - 40mats (30 persons)× 3 rooms (Max. 105 persons) no stage
  - 20 mats (12 persons)× 1 room no stage
  - Dug-out Kotatsu (table) (8persons)× 2 rooms
- Restaurant [Marusukoi]
  - 1F / 500 seats 2F / 412 seats
- Restaurant Hyokai
- Conference Room / 60 persons × 1 room ( can be divided into 3)
- Game Corner
- Family Bath (reservation necessary) / 2 rooms
- Pub Etopirika / 80 persons
- Laundromat
- Gift Shop Jerebo
- Coffee Shop Shiomi
- Ramen-Tei
- Karaoke Box / 15 persons 1 room

- Public Hot Spring Bath [Somoro]
    - BF Sonte (Sun) 600 m<sup>2</sup> (Children's pool, slide, playground, Jacuzzi)
    - 1F More(Ocean) 1,000 m<sup>2</sup>
    - 2F Rosha (Forest) 1,000 m<sup>2</sup>
- Each ( Bath with a view, Sauna, Outdoor bath, Electric Bath, Waterfall bath, lounge bath, Herbal bath, Cold bath. Maximum capacity for each is 200 persons.
- Total area: 3,400m<sup>2</sup> (including changing area)  
Spring quality: Sodium, Hydrogen-carbonate spring 61 Degrees Celsius  
Effective for: Rheumatism, motor system disabilities, burns, chronic rash, keratosis, pruritus, and menopausal symptoms.

### East Wing

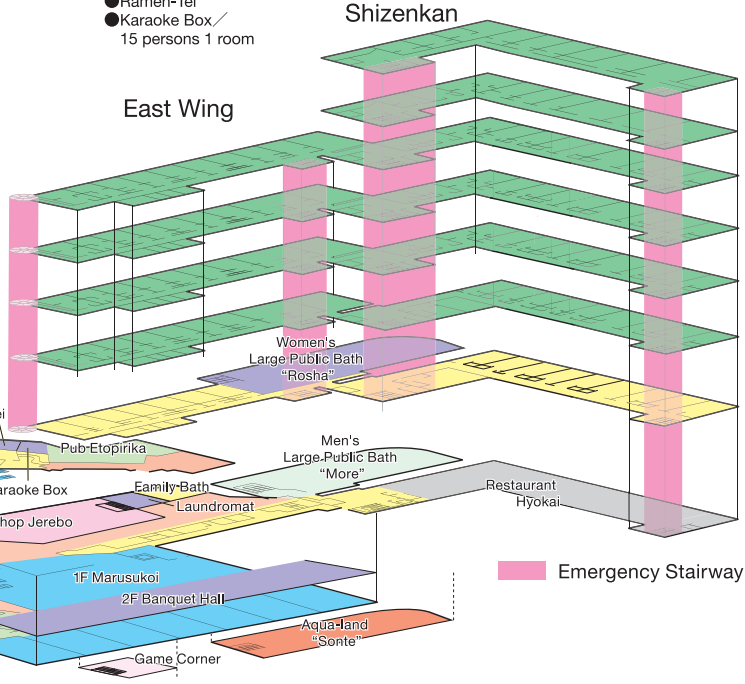

Emergency Stairway

### West Wing

10F●Guest Rooms (1001~1021)	●Vending Machines (2 in EV Hall)
9F●Guest Rooms (901~921)	●Vending Machines (2 in EV Hall)
8F●Guest Rooms (801~821)	●Vending Machines (2 in EV Hall) ●Ice Machine
7F●Guest Rooms (701~721)	●Vending Machines (2 in EV Hall)
6F●Guest Rooms (601~621)	●Vending Machines (2 in EV Hall) ●Ice Machine
5F●Guest Rooms (501~521)	●Vending Machines (2 in EV Hall)
4F●Guest Rooms (401~431)	●Vending Machines (2 in EV Hall)
3F●Conference Room	
2F●Marusukoi ●Ramen-Tei ●Pub Etopirika ●Karaoke Box	
1F●Front Desk ●Lobby ●Lounge ●Coffee Shop Shiomi ●Gift Shop Jerebo ●Banquet	

### East Wing

6F●Guest Rooms (651~662)	●Vending Machines (2 in EV Hall)	6F●Guest Rooms (671~680) ●Ice Machine
5F●Guest Rooms (551~562)	●Vending Machines (2 in EV Hall)	5F●Guest Rooms (571~580) ●Ice Machine
4F●Guest Rooms (451~462)	●Vending Machines (2 in EV Hall)	4F●Guest Rooms (471~480) ●Ice Machine
3F●Guest Rooms (351~362)	●Vending Machines (2 in EV Hall)	3F●Guest Rooms (371~383)
2F●Guest Rooms (251~256) ●Rosha ●Vending Machines (1 in EV Hall)		2F●Guest Rooms (271~283) ●Ice Machine
1F●Gift Shop Jurebo ●Marusukoi ●More ●Family Bath ●Laundromat ●2F Banquet ●Smoking section		1F●Restaurant Hyokai
BF●Game Corner ●Sonte		

### Shizenkan (All rooms are non-smoking)

8F●Guest Rooms (871~880)
7F●Guest Rooms (771~780)



Shiretoko Mountain Range

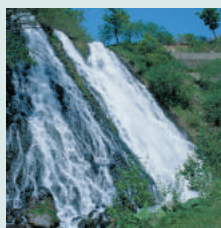

Oshinkoshin Water Fall

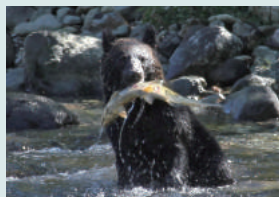

Higuma (brown bear)



Shiretoko Goko (Five) Lakes



Clione



Drift-ice



Steller's Sea Eagles

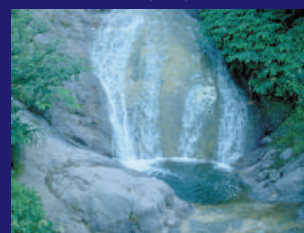

Kamuiwakka Hot Falls

Natural World Heritage where lush untouched nature remains.

# Shiretoko

Seasonal expressions of nature leave a deep impression upon us. Abundant discoveries make us meek, while the comfort and loveliness of the great outdoors makes our hearts gentle.



## Transportation Guide

### Flights

- Memanbetsu Airport
- Kushiro Airport
- Nakashibetsu Airport
- Okhotsk Monbetsu Airport

### Bus

- Senmo Line Shari Station
- Shiretoko Line, for Utoro Hot Springs ..... 50 min.

### Car

- From Memanbetsu Airport ..... 120 min.
- From Kushiro Airport ..... 240 min.
- From Nakashibetsu Airport ..... 120 min.
- From Kushiro Airport ..... 180 min.
- From Abashiri Station ..... 80 min.
- From Shiretoko-Shari Station ..... 40 min.



Mt. Rausu



Shiretoko in the Fall